

[034Motorsport Dynamic+ Rear End Link Kit, MQB](#)**034 MOTORSPORT**

These end links were engineered with performance, and more importantly, strength and longevity, in mind. Manufactured from 304 stainless and zinc plated steel, for strength and long-lasting reliability.

**Installation Spiciness Rating**

(Mild)

Installation of your 034Motorsport Front Sway Bar End Link Kit is a straightforward process that will take approximately 30 minutes to complete.

**Supplied Parts:**

- (2x) dynamic+ rod ends with hardware
- (2x) dynamic+ rod end bushings with jam nuts
- (2x) M10 nylon locking nuts
- (2x) M10 washers
- (1x) anti-seize packets

**Tools Needed:**

- 6mm triple square allen
- 5mm allen
- 13mm wrenches
- 16mm wrenches
- 17mm wrenches
- Torque wrench

### About This Guide

This Install Guide documents the installation process on a 2016 Audi S3 and 2018 Audi RS3. There may be minor differences on other vehicles, depending on specific vehicle, market, options, etc.

### Getting Started

- Confirm you have received all the parts included with your purchase by reading the complete guide, if there are missing components, please contact [customerservice@034motorsport.com](mailto:customerservice@034motorsport.com)



## Assembly Steps

### Step A

Open hardware packages



**Step B**

Apply half packet of anti-seize to each rod end

**Step C**

Run the jam nut down the shaft to disperse the anti-seize along the entire threaded portion



**Step D**

Mate the two rod ends together

**Step E**

Insert M10 washer and locking nut



You are now ready to start the installation process.

### Installation Steps

#### Step 1

Raise the vehicle securely on jack stands, or a lift, to gain access to the rear suspension



#### Step 2

Using two 13mm wrenches, remove the bolt and nut securing the bottom of the end link to the lower control arm. Using a 16mm wrench and 6mm triple square, remove the nut securing the upper end link to the rear sway bar



**Step 3**

Determine which setting you will be using on the sway bar and adjust the end link spacer orientation accordingly

Upper link orientation should be rotated 90 degrees from lower link

Lock links in position by holding upper link with a 17mm wrench and tightening the jamb nut with a 19mm wrench

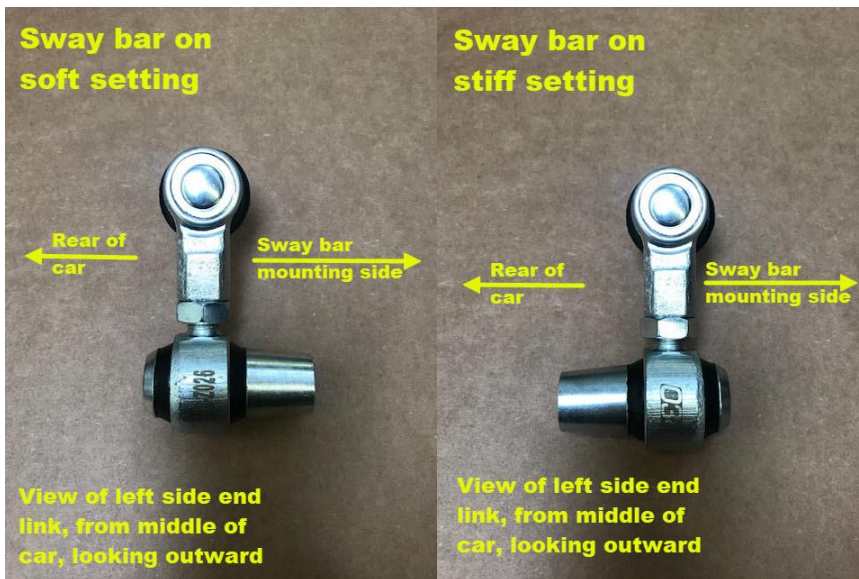
**Step 4**

Install the 034Motorsport Dynamic+ End Link into the lower control arm. Secure using the factory bolt and supplied M8 lock nut. Torque to 35 Nm



**Step 5**

With a 17mm wrench and 5mm Allen, secure the top of the end link to the rear sway bar using the supplied M10 nut and washer. Torque to 45 Nm.

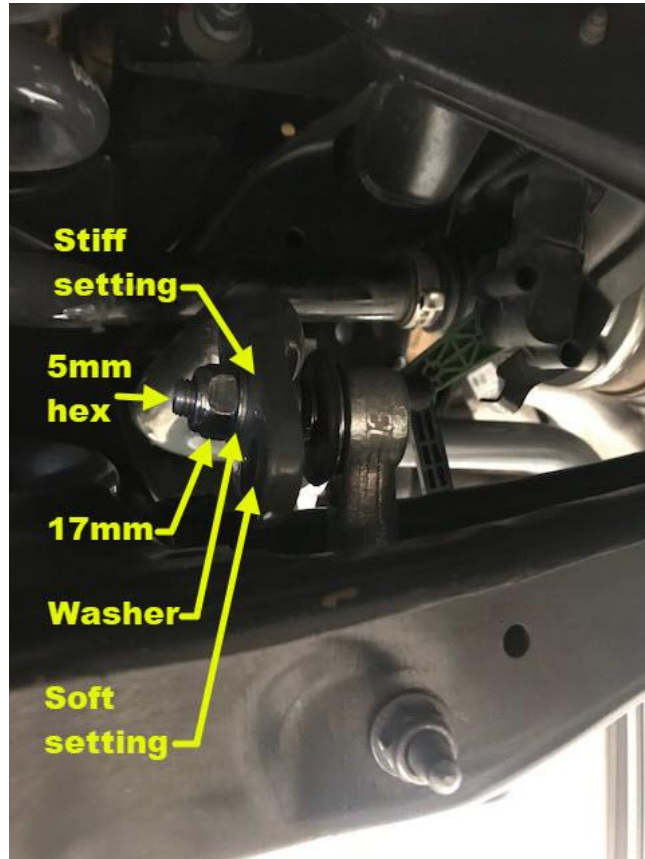
**Step 6**

Repeat steps 2-5 for the opposite side and enjoy!

